

ROOM SPECS: FIRST YEAR & UPPER CLASS HALLS BUTLER AND GENTLE HALLS

TOTAL SQ. FOOTAGE:

Approximately 380 square feet - Room dimensions may vary

LIVING ROOM: - Approximately 180 square feet - 10' 4" X 17' 7".

Specific room dimensions may vary. All living rooms provide natural light and ventilation via several windows. The living room space is combined with a study area that can accommodate up to 4 students. Each student is provided a desk area, bookshelf and chair. Data, phone and Cable TV connections are available here, and each living room area is furnished with a couch, 1 guest chair, and floor lamp.

BEDROOM: - Approximately 200 square feet - 11' 10" x 19'

Specific room dimensions may vary. Bedrooms in Butler, and Gentle Halls were originally set up to accommodate 4 students, though generally, 2-3 students are placed in a unit unless space dictates otherwise. Each bedroom is equipped with 3 extra long single beds (Mattresses are 80" long), one wardrobe unit/student which also provides 3 drawers for storage. Bedrooms are a separate room from the living/studying area and have an adjoining bathroom within each unit.

BEDROOMS ARE FURNISHED WITH THE FOLLOWING:

BED:

WIDTH: 3' 6"

LENGTH: 6' 10"

MOVEABLE: Yes

STACKABLE: Yes, with restrictions

STORAGE BENEATH: Yes, variable

NIGHTSTAND:

HEIGHT: 29.5"

WIDTH: 24"

DEPTH: 16"

One Adjustable Shelf

WARDROBE:

HEIGHT: 6' 10"

DEPTH OF UNIT: 2'

WIDTH: 3'

OF DRAWERS: 2

ROOM ON TOP: Yes

HOW MUCH?: 1' 5"

MOVEABLE?: No

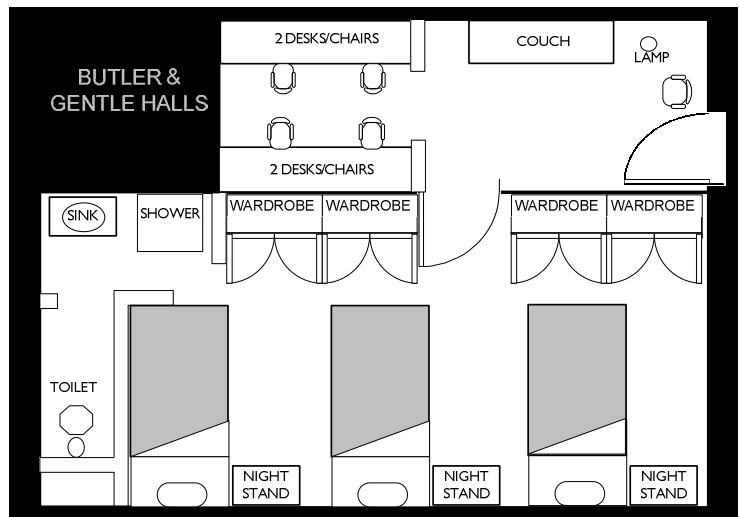

DESKS LOCATED IN THE LIVING AREA ARE FURNISHED WITH A CHAIR AND ARE SET UP AS FOLLOWS:

DESK:

HEIGHT: 2' 7"

DESKTOP WIDTH: 7'

DESKTOP DEPTH: 2'

MOVEABLE?: No

